

Qty: 5 Ref: 517 Road narrows on one side only ahead - right		Qty: 2 Ref: 72021 Temporary lane availability	
Qty: 1 Ref: 572 Distance ahead to hazard		Qty: 2 Ref: 72021 Temporary lane availability	
Qty: 1 Ref: 572 Distance ahead to hazard		Qty: 2 Ref: 72021 Temporary lane availability	
Qty: 2 Ref: 572 Distance ahead to hazard		Qty: 2 Ref: 72021 Temporary lane availability	
Qty: 3 Ref: 573 Direction to hazard left		Qty: 1 Ref: 7245 Controlflow Exit Crossover	
Qty: 1 Ref: 573 Direction to hazard right		Qty: 1 Ref: 7245 Controlflow Entry Crossover	
Qty: 2 Ref: 510 Keep left		Qty: 2 Ref: 7301 Works access	
Qty: 4 Ref: 510 Keep right		Qty: 2 Ref: 7302 Works exit	
Qty: 16 Ref: 570 50 mph maximum speed limit		Qty: 2 Ref: ERV End of roadworks / 30mph speed limit	
Qty: 4 Ref: 570 50 mph maximum speed limit		Qty: 2 Ref: ERV End of roadworks / 50mph speed limit	
Qty: 7 Ref: 7001 Road works ahead		Qty: 5 Ref: ERV End of roadworks / Speed limit	
Qty: 7 Ref: 7105 Lane closure barrier			

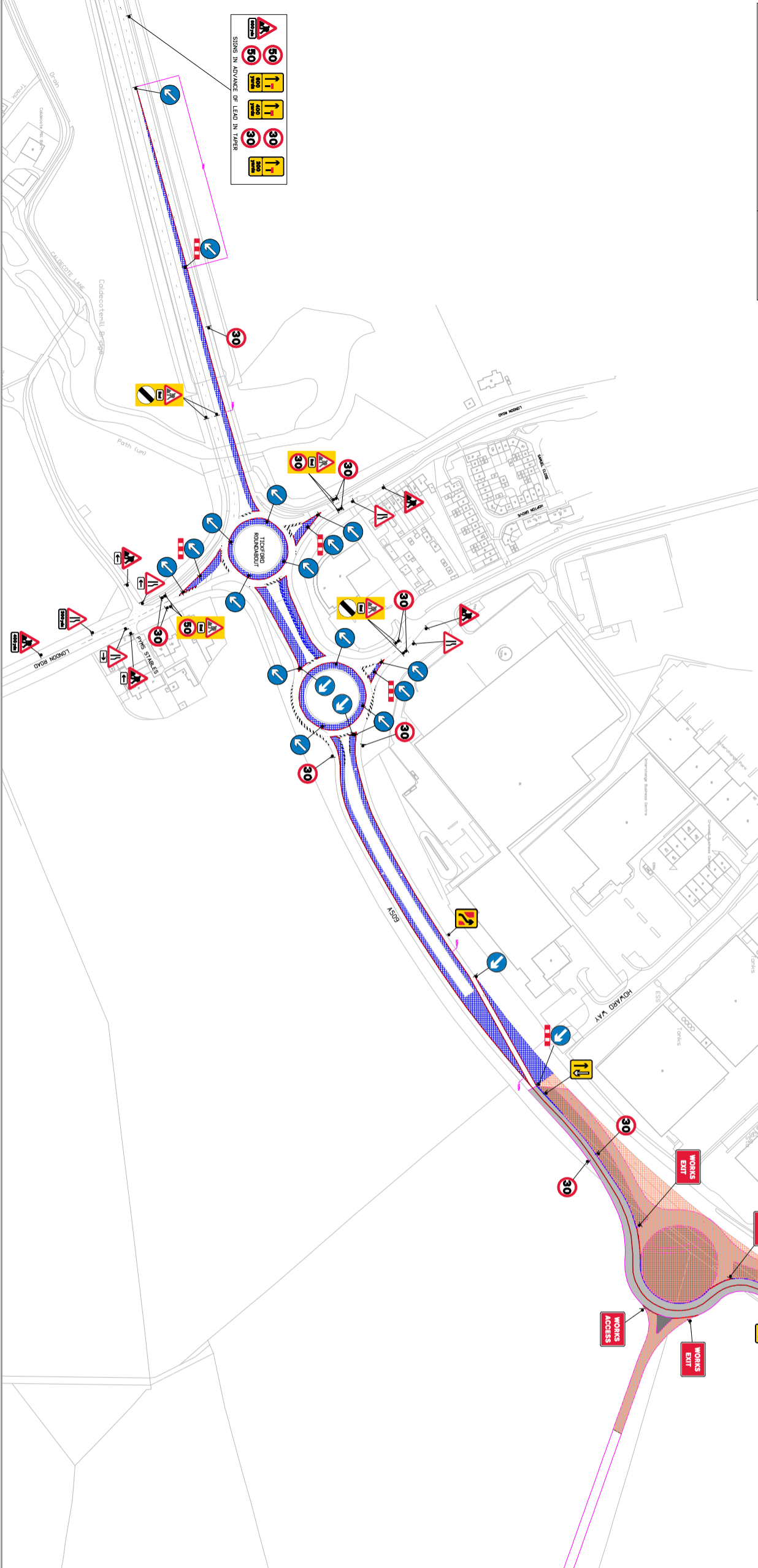

SIGNS IN ADVANCE OR LEAD IN TAPER

Chevron
Traffic Management

Drawing Notes

Cone lights spaced minimum 9m, cones to be 750 mm or 1m
All works to be carried out as per safety at streetworks and roadworks "A Code of Practice" October 2013.
CPA conditions apply unless otherwise agreed.

Traffic Management Key

	Area of Works
	Safety Zones
	Road Signs
	Road Cones
	Pedestrian Barrier
	Ramps
	No Waiting Cones

Site Details

Traffic Management	Lane Closure
Speed of road (mph)	
Minimum sidewalks safety zone (S)	1.2m
Minimum longways safety zone (L)	60m

Additional Notes:

Drawing Office

DRAWING NUMBER	TM-CR222977-1
CONTRACT NUMBER	TM-Q222977
PAGE NUMBER	4 of 5
SURVEYED BY / DATE	1 of 1
DRAWN BY / DATE	Customer
CHECKED BY / DATE	KS 15/01/26
APPROVED BY / DATE	KF 15/01/26
CLIENT REF	TBC
SCALE	@ A3

Client

MW KELLY
CIVIL ENGINEERING

Site Address

A509
Newport Pagnell
MK16 9PX

Co-ordinates, Latitude - Longitude

52.079980, -0.699284